

FORM NO. 1.

Courses and Distances  
Beginning at a White Oak  
and by Land of W<sup>m</sup>. McCartney

- N. 54 W. 99 to White Oak by same.
- N. 75 W. 57 To Post and by Land of Martha Reed.
- S. 32 E. 39 To Hickory by same.
- S. 45 W. 10 to Beech same.
- N. 63 W. 18.
- S. 80 W. 56 To Locust.
- S. 19 W. 20 Hickory
- S. 18 E. 104 Post. and by Foot of Lost Creek Ridge.
- N. 70 E. 144 To Birch by same
- S. 85 E. 66 Butterwood.
- N. 34 E. 48 Black Oak.
- N. 20 W. 20 To White Oak and by John Holmes.
- N. 52 W. 26 to Black Oak and Down Lost Creek
- S. 47 W. 46 to Beginning.

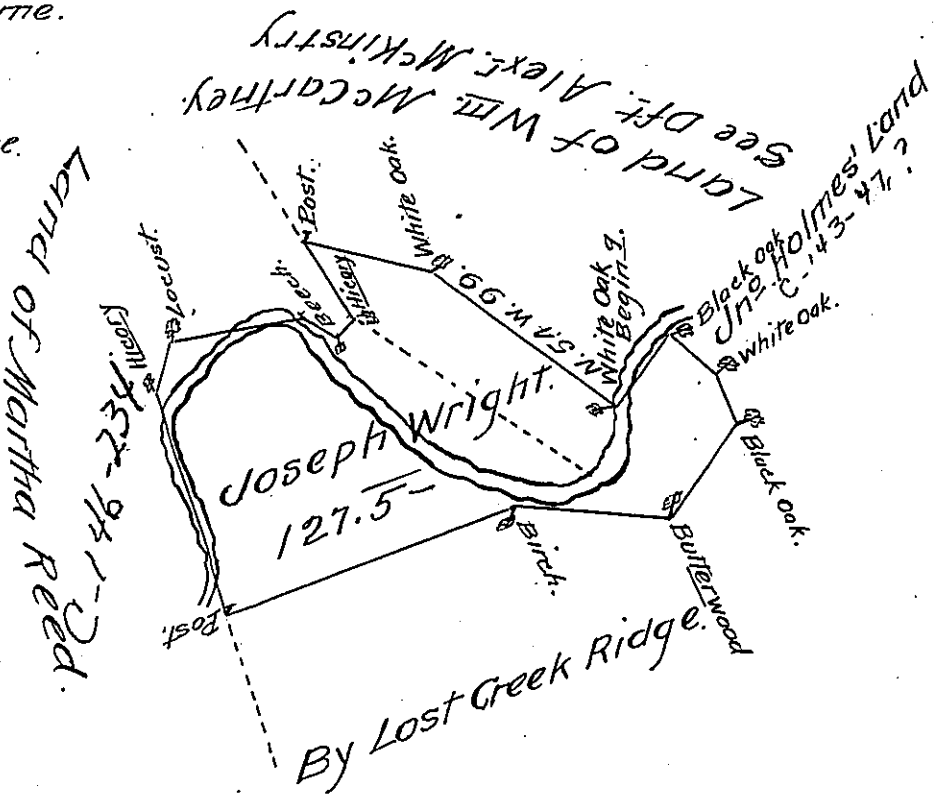

The Draught of a Tract of Land called Kingwood  
situate on Both Sides of Lost Creek in the County of Cum-  
berland containing One Hundred Twenty Seven Acres and  
an Half acre with the usual allowance of six Acres  $\frac{1}{2}$  Cent.  
for Roads. Survey'd the 20<sup>th</sup>. day of September Anno Dom. 1770  
In Pursuance of an Order of Survey to Joseph Wright Bearing  
date at Philad<sup>a</sup>. the 4<sup>th</sup>. day of August Anno Dom. 1767 No.  
4263 and agreeable to the Determination of the Board of Prop-  
erty of the 1<sup>st</sup>. May 1770 Joseph Wright v- W<sup>m</sup>. McCartney.

To John Lukens Esq<sup>r</sup> }  $\frac{1}{2}$  W<sup>m</sup>. Maclay D.S.  
S. G. of Pennsylvania - }

The dotted line from the Hickory to the Creek shows what Land  
is taken off from the Land survey'd for McCartney and included in this survey.

See Alex<sup>r</sup>. McKinstry's Dft. on wt. of 10<sup>th</sup> June 1762 Regulated a-  
greeably to y<sup>e</sup> above. Now in Fermanagh Township Mifflin Co.

IN TESTIMONY that the above is a copy of the original remaining on file in  
the Department of Internal Affairs of Pennsylvania, made  
comformably to an Act of Assembly approved the 16th day of  
February 1833, I have hereunto set my hand and caused  
the Seal of said Department to be affixed at Harrisburg,  
this twenty ninth day of April 1907.

*Isaac N. Brown*  
Secretary of Internal Affairs.